

RoHS COMPLIANT

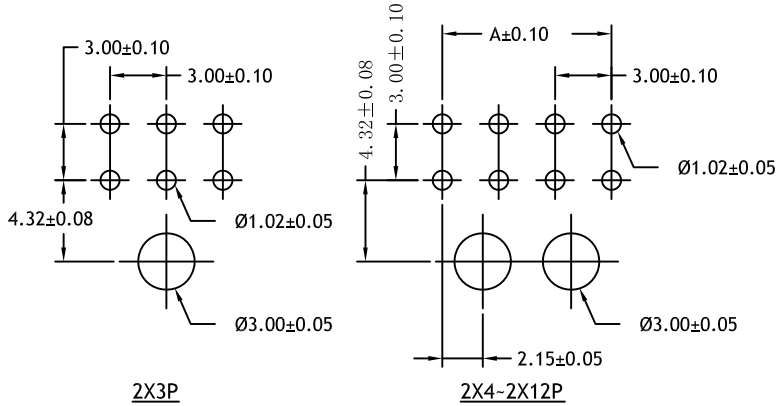

RECOMMENDED P.C.B. LAYOUT  
ALL TOLERANCES ARE ±0.05

Specifications:  
 Current Rating: 5.0A AC/DC  
 Voltage Rating: 250V AC/DC  
 Contact Resistance: 10m ohm. Max.  
 Insulation Resistance: 1000M ohm. Min.  
 Withstanding Voltage: 1500V AC For One Minute  
 Operating Temperature Range: -40°C To +105°C  
 Materials:  
 Pin Material: Brass/Tin-Plated  
 Material: PA46  
 Color: Black

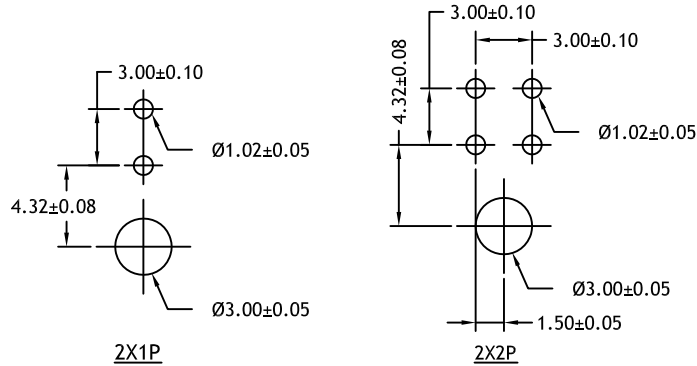
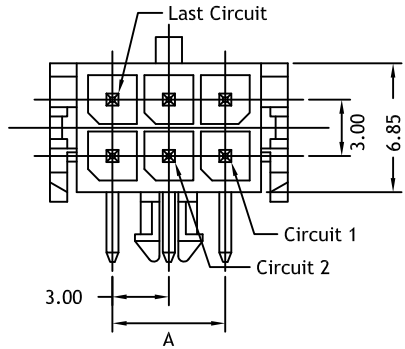
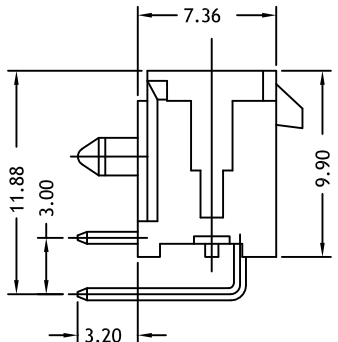
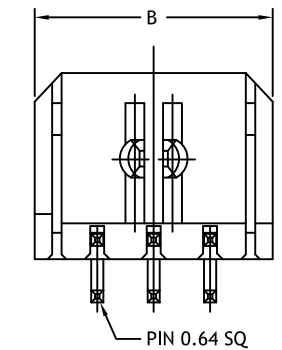

Ordering Information & Dimensions

PIN NO.	Dimensions	
	A	B
01	---	6.65
02	3.00	9.65
03	6.00	12.65
04	9.00	15.65
05	12.00	18.65
06	15.00	21.65
07	18.00	24.65
08	21.00	27.65
09	24.00	30.65
10	27.00	33.65
11	30.00	36.65
12	33.00	39.65

Part number Information:

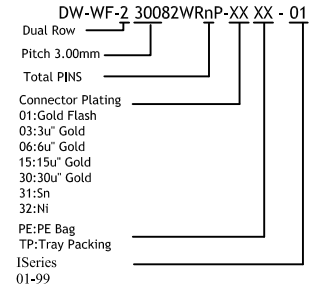

ECN NO.	REV	DATE	DESCRIPTION	CHANGE	APPRO.	GENERAL TOLERANCE UNLESS OTHERWISE NOTED	SCALE: N/A	UNIT: mm	A4	SHEET: 1 of 1
						Angle ±2°	DESIGN	Aple	2018.06.01	
						X.X ±0.35	CHECK	Jason	2018.06.01	
	A-1	2018.06.01	Updated spec	Michael	Rix	X.XX ±0.30	APPROVAL	Rix	2018.06.01	
	A-0	2016.12.29	NEW	Michael	Rix	X.XXX ±0.20				

龍威電子有限公司  
 Dragon Well EleDragon Well Electronics Co.,Ltd  
 TITLE: 3.0mm Pitch 90° Wafer, DIP  
 MODEL NO. DW-WF-230082WRnP-XXXX-01  
 THIS DRAWING CONTAINS INFORMATION THAT IS PROPRIETARY TO DRAGON WELL AND SHOULD NOT BE USED WITHOUT WRITTEN PERMISSION